

GIESSE OPEN SYSTEM SLIDE

GIESSE GOS-S T-REX SYSTEM

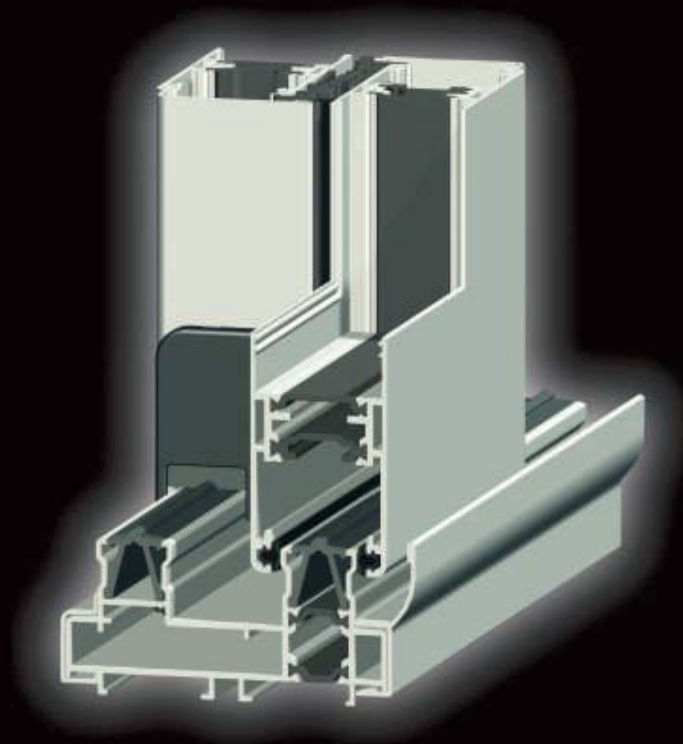

The sliding system with the high performance of swing doors and windows

 **GIESSE**[®]
www.giesse.it

GIESSE **GOS-S T-REX SYSTEM**

Giesse has developed a system which reinvents the sliding sash as a solution able to satisfy the highest demands in terms of comfort and lifestyle.

GOS[®]-S is a system of fittings and mechanisms designed by Giesse which, when combined with the profiles developed ad-hoc by the major profile manufacturers worldwide, offers the window and door fabricator a sliding system

which is water, air and wind proof, thermally and acoustically insulated, and secure **against intrusion**, like a high quality swing window or door installation.

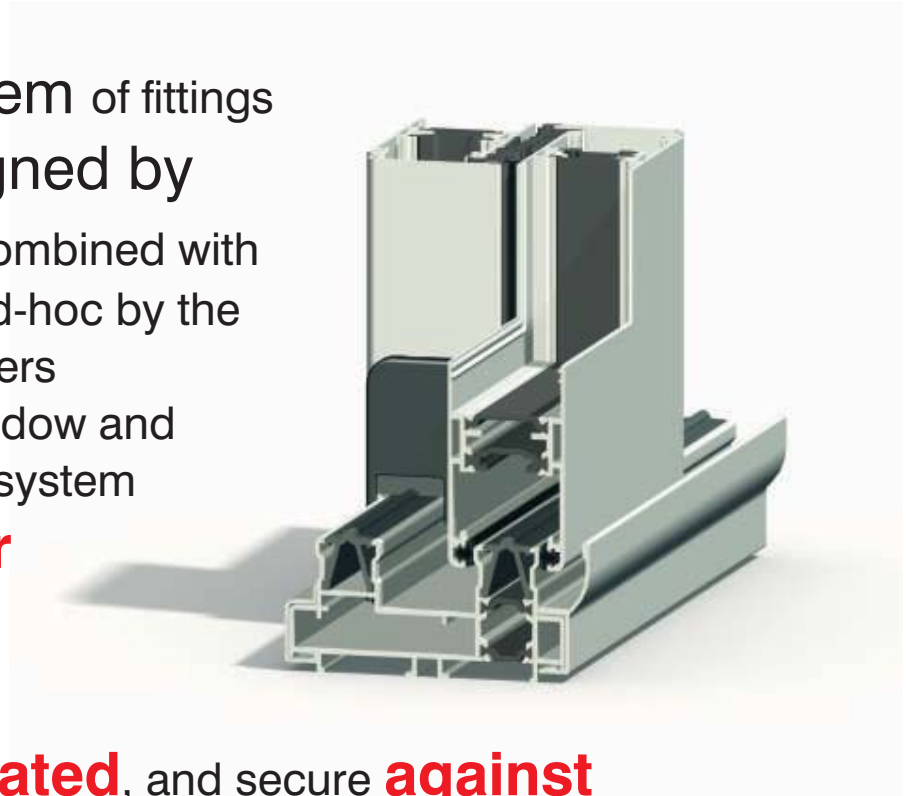

GIESSE GOS-S T-REX SYSTEM

Performance

1

Thermal insulation:
 $U_w < 1.8 \text{ W/m}^2\text{K}$



At a time when lifestyles and standards both demand the highest possible performance from external window and door installations, GOS-S is GIESSE's proposal which does away with the traditional limitations of sliding doors and windows.

the thermal transmittance, air and water tightness and acoustic insulation, tested according to EN standards, are equivalent to those of the best swing door and window systems.

2

Air tightness:
Class A4



3

Watertight:
1,050 Pa



4

**Noise reduction:
40 dB**



5

**Wind resistance:
up to 3,000 Pa
(equal to gusting at 260 kph)**



6

**Intrusion-
security: Class 2**

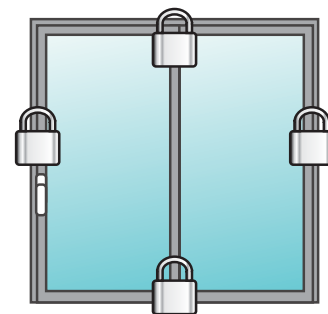

The profile geometry, use of gaskets as a sealing system and GIESSE's innovative range of fittings all make GOS-S the first sliding door/window system with exceptional insulation performance.

The option to fit locking components to all sides of the sash vastly increases the GOS-S system's intrusion resistance.

GIESSE GOS-S T-REX SYSTEM

Thermal insulation

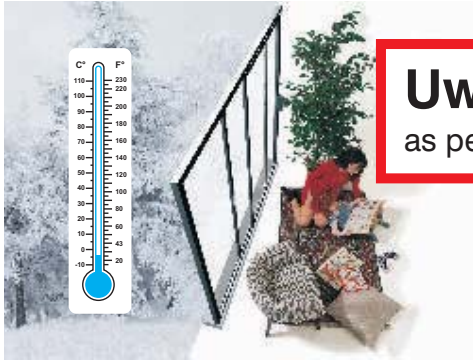

$U_w < 1.8 \text{ W/m}^2\text{K}$
as per EN 10077-1/2

In traditional sliding window and door systems, **transverse heat losses through the surface** combine with **significant longitudinal losses** due to the fact that the thermal insulation of the frame does not prevent dispersion along its metal parts exposed to the interior and exterior.

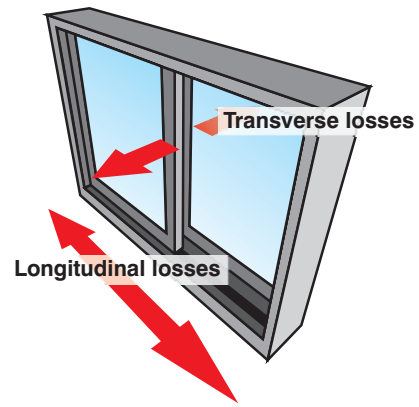

The GOS-S system eliminates **transverse losses** by increasing the thermal insulation of the profiles.

Longitudinal losses can account for up to **25%** of total losses.

A completely unique **system** is used to reduce longitudinal losses:

the GOS-S with the T-REX frame joint.

T-REX[®]

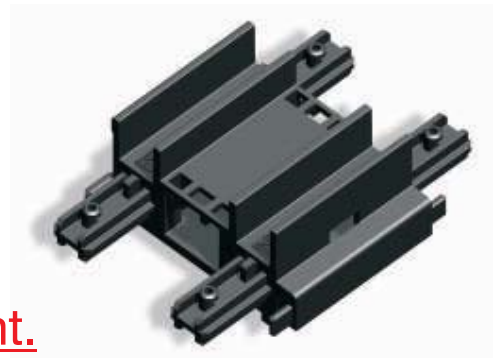

T-REX is a Giesse **international patent.**

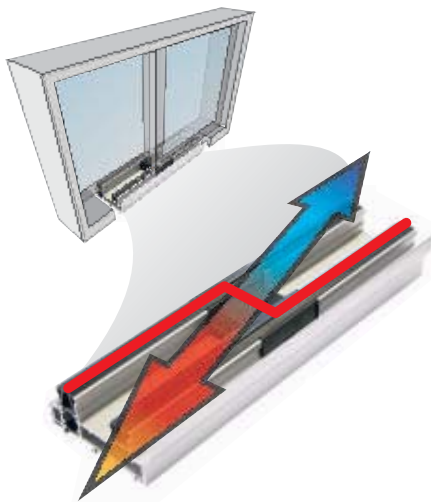

The T-REX joint is installed centrally on the frame's **upper and lower cross beams at the central profile.**

The frame has a thermal insulation in line with that of the sashes themselves. The T-REX, applied centrally, combines the thermal insulation of the frame at various planes **and thus shuts off longitudinal thermal losses.**

The thermal insulation no longer has the traditional rectilinear profile, but is rather segmented to form a "Z". This is how the T-REX shuts off longitudinal thermal losses.

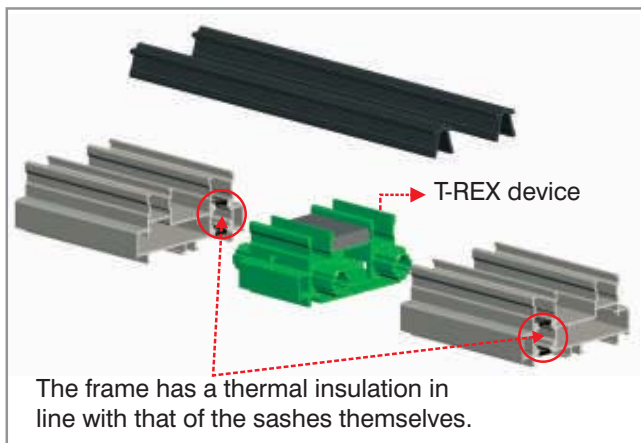

The "Z"-shaped thermal insulation of a GOS-S frame mounting the T-REX system

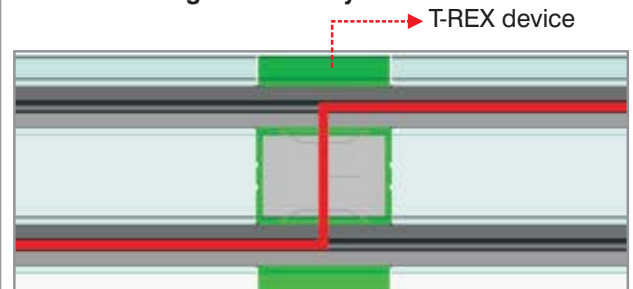

Thermal chart of a traditional sliding sash system

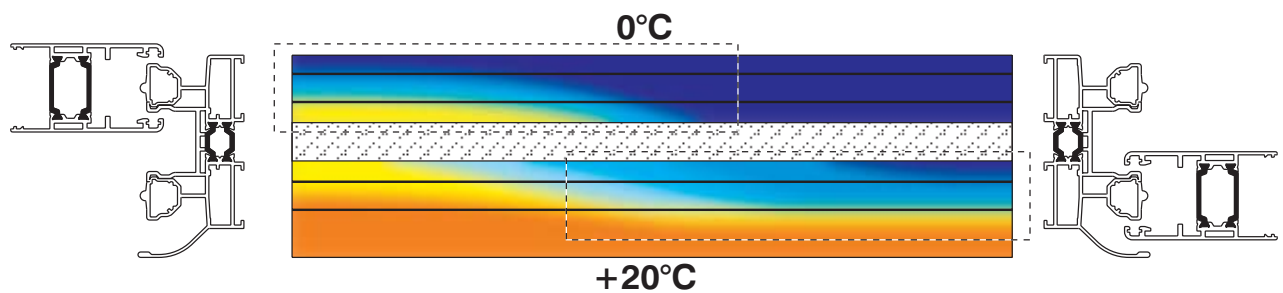

Thermal chart of a GOS-S T-REX sliding sash system

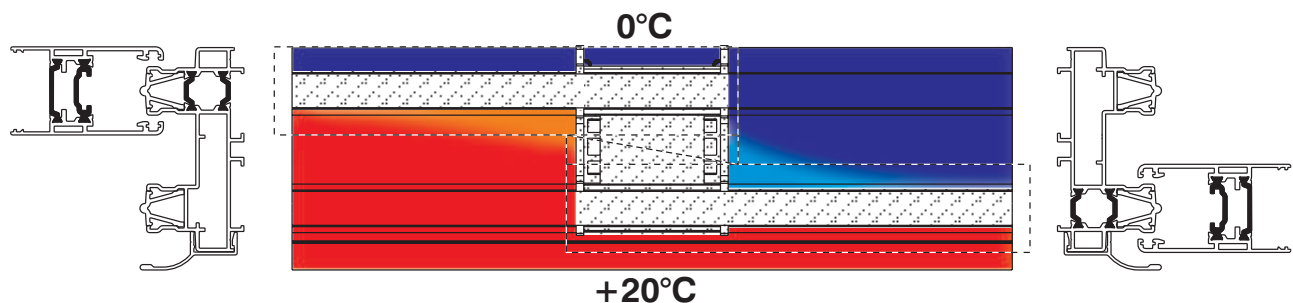

GIESSE **GOS-S T-REX SYSTEM**

Air and water proofing

The GOS-S provides air and water proofing equivalent to that of an excellent swing sash system. Using **perimeter gaskets**, **innovative seals** on the central profile and **high drainage capacity** due to the T-REX device, the performance of the system is

absolutely outstanding. Air tightness is guaranteed by the same equipment which provides the waterproofing.

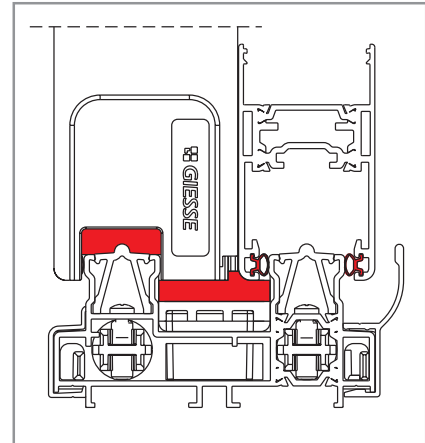

Air tightness: Class A4
under EN1026

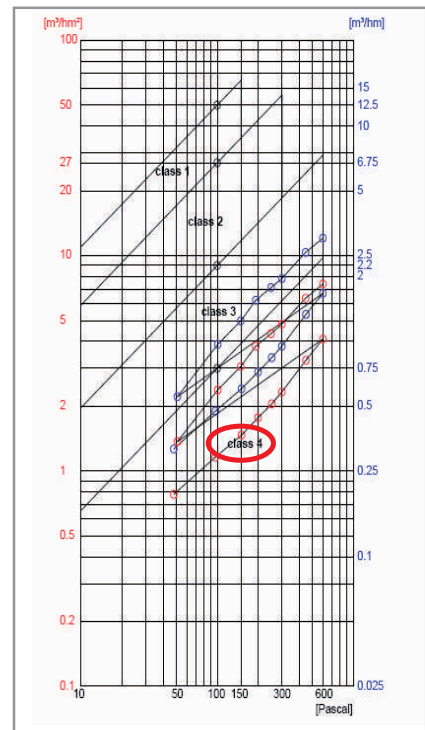

Watertight: 1,050 Pa
under En1027



GIESSE GOS-S T-REX SYSTEM

Noise reduction

-40 dB

under EN140/3 and EN717/1

In recent years, noise pollution has reached levels which has made it necessary to issue standards and legislation governing building works to reduce the disturbance it causes.

Not only public buildings (schools, hospitals and so on) but also private residences are increasingly affected by this requirement, as the need for quality of living is particularly felt in such contexts.

The GOS-S T-REX system uses extremely effective air tight components and special acoustic glass to satisfy the most stringent demands for soundproofing.



Wind resistance

3.000 Pa

under En12211

The configuration of the profiles provides resistance up to 3,000 Pa, which corresponds to **gusts of wind of 260 kph!**



GIESSE GOS-S T-REX SYSTEM

Intrusion security

According to burglary statistics, more than 70% of intrusions are via windows and French windows and not, as we might expect, via the main entrance of a building.

The response to this is to be found in windows and doors built with especially resistant profiles, using special fittings to satisfy established intrusion standards.

In its standard configuration, GOS-S T-REX already provides excellent security with locking points capable of resisting, up to 600 Kg of traction

each and components which prevent the sash being forced upwards.

If we wish to satisfy **Class 2** requirements, GOS-S T-REX is ready for armoring the profiles externally.

- This option must be combined with special fittings, including:
- Security locks
- Class 2 rise-proof kit
- External intrusion boss



Class 2
under ENV1627:2000



Security locks



Class 2 rise-proof kit



External intrusion boss

The Istituto Giordano has tested the GOS-S system under the terms of ENV 1627:2000, and certified it to satisfy the requirements of a Class 2 system.



GIESSE GOS-S T-REX SYSTEM

Other advantages

1

Competitive system (simple and fast)

The GOS-S system has been designed to minimise frame and sash fabrication processes. All operating and closure fittings are fitted in a channel without the need to machine the profile itself. GOS-S ensures time savings and optimised production.



2

Modular

The polyamide rod (C.E.), which connects all fittings, enables you to fabricate doors and windows of varying sizes and configurations using a small number of parts. The fittings are the same for doors and windows, excepting the carriages. GOS-S thus reduces your stock requirements while increasing your production flexibility.

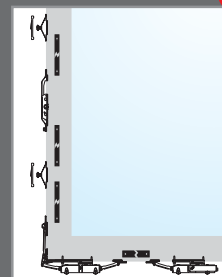

3

Reliable

All GOS-S fittings are fabricated in high quality materials and tested to the most demanding standards; the operating and closure fittings are tested to 25,000 cycles under EN13126 and are rated Class 4 corrosion resistant under EN1670.



Classe 4
secondo EN1670

25.000 cicli
secondo EN13126

4

Aesthetics and design

GOS-S window and doors can mount cremones, window handles or handles in any desired finish. The rounded form of the profiles and the stylish fittings make the GOS-S system the right choice for any setting. GIESSE offers GOS-S partners the option to choose their own line of handles as an exclusive for them alone.



GIESSE GOS-S T-REX SYSTEM

Competitive

The GOS-S T-REX system has been designed to not require profile machining (except for that required for cremones and window handles) when mounting the fittings. This enormously simplifies **door and window production** and **speeds up the work** of the fabricator.

All fittings, whether operating or locking, are mounted in the 15/20 channel in the sash - with evident

benefits for the production process. **The entire equipment** for a single sash (kit of carriages, corner mechanism, 3 locking and operating points) **can be mounted in under 3 minutes**. The counterplates apply to the frame without the need for any machining.



Reduced fabrication and installation time

Along with its excellent drainage properties, T-REX considerably reduces the time required to fabricate the window or door. The water which builds up in the frame is drained off by the T-REX system, and there is thus no need to machine the profile to fit drain caps or tubes - a significant time saving. Another cost saving (installation time and costs)

provided by the T-REX system consists in the elimination of the plastic U profile which must normally be fitted to traditional sliding frames.

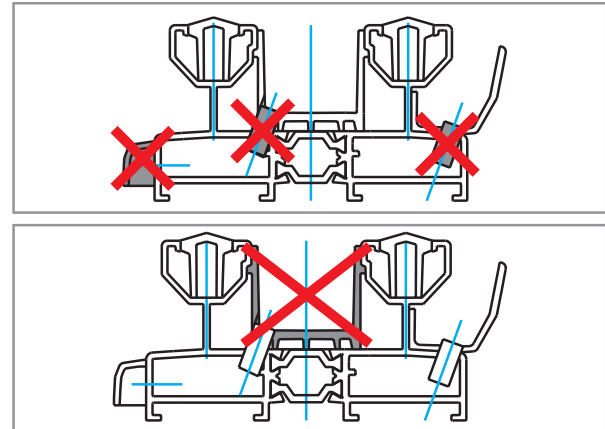

Modular

The European groove channel polyamide rod is used to connect the fittings, whether operating (carriages) or locking (closure points, operation, lock, etc.). This results in a very modular system which allows you to fabricate windows and doors of a range of sizes and configurations using a small number of fittings. In order to further facilitate the work

of the stock purchaser, almost all fittings can be used for both windows and doors. Only the carriages are specifically designed for either windows or doors - the system thus reduces stock and increases production flexibility.

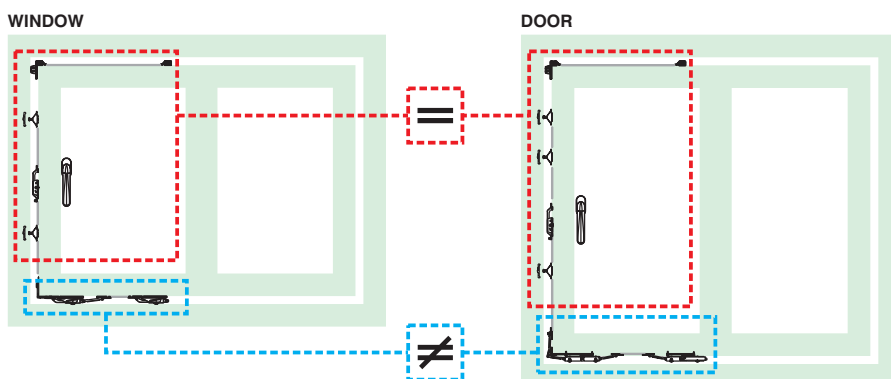

GIESSE **GOS-S T-REX SYSTEM**

Reliable

The reliability of GOS-S T-REX fittings is due to the use of **high quality materials** and **rigorous testing** of all parts.

The L&S carriages are tested under the terms of the highest specifications of EN 13126-16/2008 - **25,000 operating cycles** for:

- Kit of L&S carriages for sashes up to 80 kg.
- Kit of L&S carriages for sashes up to 200 kg.

All GOS-S fittings are corrosion proofed using a special treatment which classifies them as **Class 4** (highly resistant).



EN 13126 - 16								
-	5	200	0	1	4	0	16	1000/2000

25.000 operating cycles

Sash weight: 200 Kg

Corrosion resistance: **Class 4**

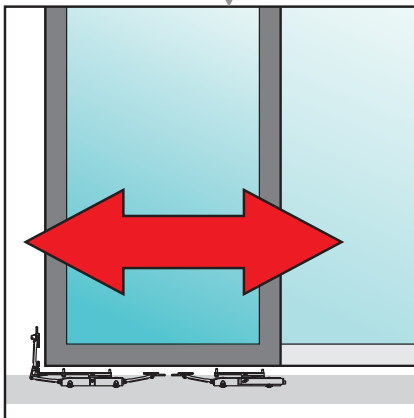

25.000 cycles
under EN13126



Class 4
under EN1670

GIESSE **GOS-S T-REX SYSTEM**

Technical specifications



GIESSE GOS-S T-REX SYSTEM

System Components

PROFILES: a limited number of profiles (the same as a traditional sliding sash) is used to make a variety of types of windows and doors (2, 3 and 4 sashes).

POLYAMIDE COMPONENTS: as well as the T.T. bars for sash and frame, the rail profile is also made of this material, which considerably reduces carriage friction and completely eliminates running noise.

SEALING SYSTEMS: the sealing system employed on the GOS-S system consists of gaskets, which not only provide an excellent seal against air and water, but also provide soundproofing.

The GOS-S is also compatible with the traditional brushes, which can be used for all non-critical applications.

FITTINGS: a new generation of fittings has been specially designed to get the best possible performance out of the system. The range is complete and enables fabrication of windows and doors of all sizes with 2, 3 and 4 sashes.

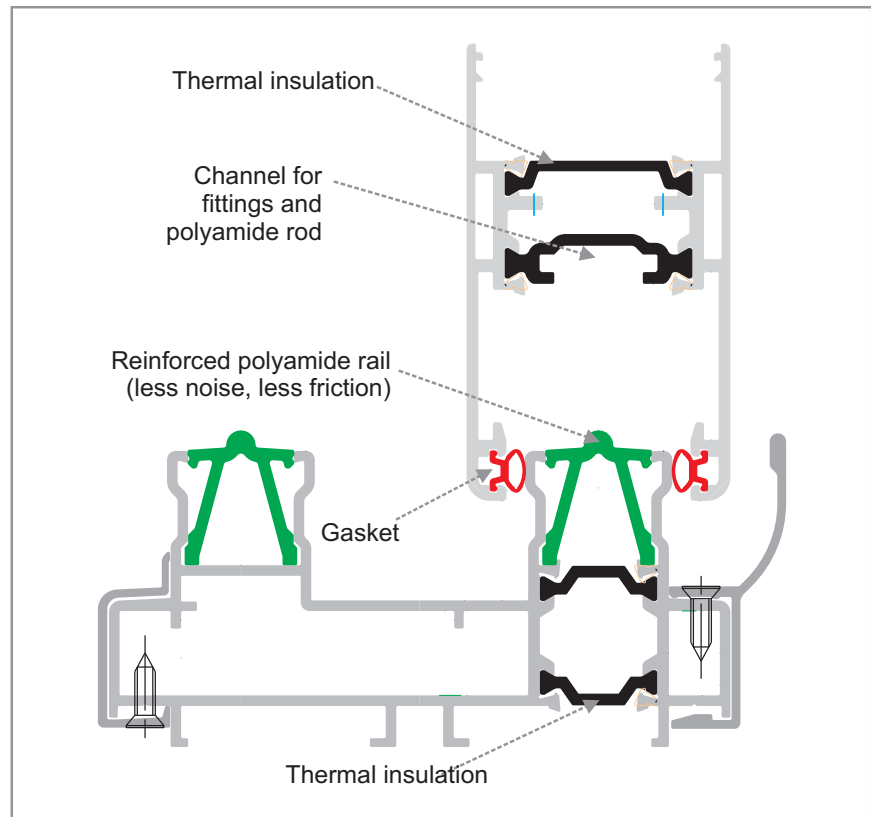

Profile specifications

Reference dimensions

GOS-S T-REX sliding sash systems are required to adhere to certain size and specification tolerances if they are to use the provided fittings and ensure excellent performance.

First of all, a **polyamide bar 15/20 (European groove channel)** channel is required for mounting the operating and locking fittings, and certain dimensional specifications for the sash, frame and mating surfaces (a sort of European groove channel for sliding installations). The other dimensions, on the other

hand, are flexible and can be decided in terms of the requirements of the market itself.

For example:

- Sash cross-section: from 40 mm (ideally 45 mm as the combination of profile cost and thermal/acoustic performance).
- Frame cross-section: from 85 mm (ideally 106 mm as the combination of profile cost and air/water seal).

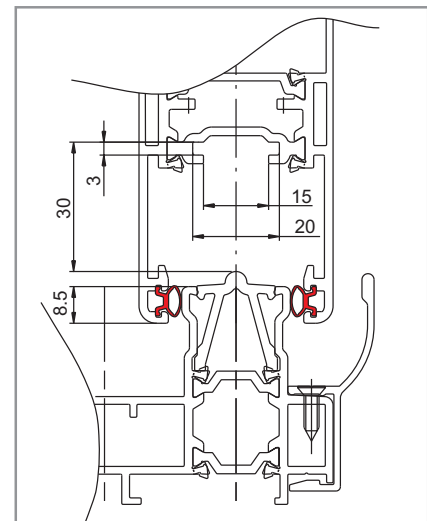

Profile fabrication

SASH: The sash profile must be cut at **45°** to use the 15/20 channel and enable installation around the perimeter of all the fittings available for the range of possible

configurations.

FRAME: the frame, depending on production and styling requirements, can be cut at either **45° or 90°**. This is at the discretion of the profile designer and does not affect the

installation of fittings, which are perfectly compatible with either solution.

GIESSE GOS-S T-REX SYSTEM

Fittings



Kit L&S Door carriage (patented)

Kit composed of a pair of 2-wheel carriages for doors of a total weight of up to 200 kg (tested to 25,000 cycles, EN13126) and a corner mechanism with snap-in mounting for faster installation.

The connection between the two carriages is provided by a polyamide rod. The carriages are equipped with a micrometer vertical adjuster (+/- 2 mm).

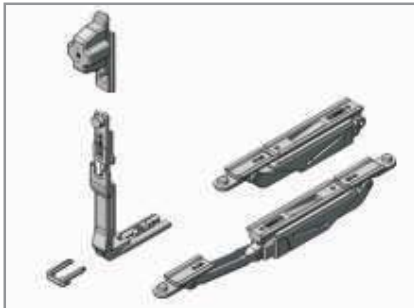

Kit L&S Window carriage (patented)

Kit composed of a pair of 1-wheel carriages for windows of a total weight of up to 80 kg (tested to 25,000 cycles, EN13126) and a T.T. Futura corner cleat.

The connection between the two carriages is provided by a polyamide rod. The carriages are equipped with a vertical adjuster (+1/-2 mm).

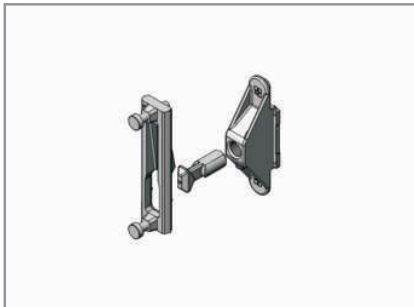

Locking kit

Kit composed of nib holder, nib and counterplate. The nib holder fits into the 15/20 channel and is actuated by the polyamide rod. The counterplate applies to the frame without the need for any machining.

The locking kit has been tested under traction with loads in excess of 500 Kg (as per the anti-intrusion standard ENV1630:2000).

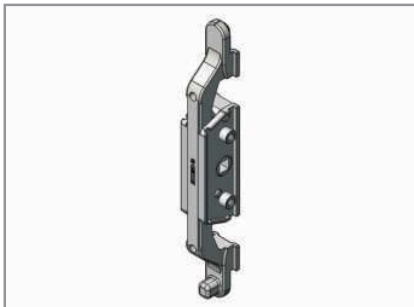

Window handle operation

Internal mechanism, channel mounting and window handle control. The locking and carriage components are operated by a connecting rod. No machining of the profile is required to fit the mechanism (except for that required to mount the handle itself).

Thanks to a mechanism on the carriages, sashes of up to 200 kg can be raised using the window handle with a standard length handle.

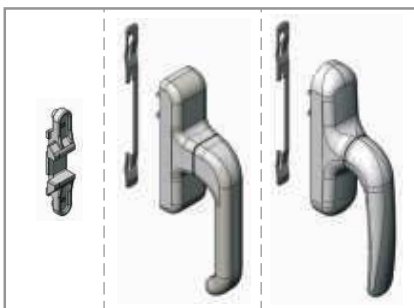

Rapid and pull cremones (patented)

The RAPID cremones (Prima or Euro, Industrial lines) are most suited for use with the GOS-S system. Their ease of installation makes profile assembly a snip - an area which is very hard to access with tools like screwdrivers and wrenches.

A rod pull has been specially developed to enable them to be used with the GOS-S system.

Thanks to a mechanism on the carriages, sashes of up to 200 kg can be raised using the window handle with a standard cremone.



L&S lever handle (patented)

Built-in handle (same as Brio), with lever action, for use on sashes up to 80 kg. The unit connects to the rod with a snap-in pin. Its reduced thickness enables it to be used on windows where it is necessary to overlap the sashes to clean the external panes.

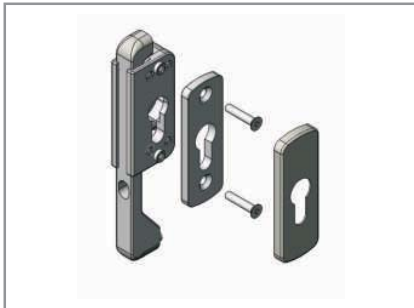

Security lock (patented)

Security device for use in combination with operating fittings when it is necessary to prevent opening from inside or enable access from outside (double window handle and double cylinder). The lock is compatible with Europeo profile cylinders and is essential for Class 2 anti-intrusion configurations.



Anti-intrusion components (patented)

In order to obtain Class 2 anti-intrusion certification, you must use not only the lock, but also the Class 2 rise-proof kit and intrusion boss. The rise-proof kit, which is controlled by a corner cleat and connecting rod, prevents the sash being raised for entry, while the external boss protects the cylinder against similar attack.

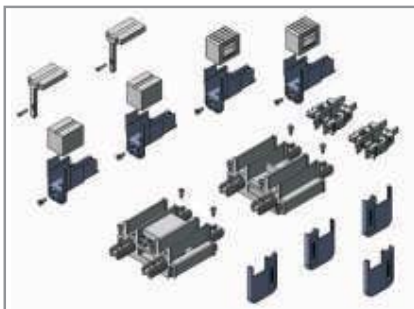

Central and T-REX cap kits (patented)

These are essential to obtaining very high water/air proofing. The pair of T-REX caps not only increases thermal insulation, but also drain water (lower cap) and contribute to sealing the middle profile along with the other fittings in the kit. The kit also includes sheathes, seal sponges (lower and upper), labyrinth plugs and covers.



Rise-proof and shock absorber plugs (patented)

These mount to the sash to prevent potentially damaging collisions with the frame when closing the sash itself. They also provide the rise-proof function. An innovative solution enables the plugs to be mounted near to the middle profile and not only at the lateral extremities of the sashes. Special fittings are available for mobile and fixed sashes.

GIESSE GOS-S T-REX SYSTEM

Fittings



Fixed sash kit

Set of fittings for securing the fixed sash to the frame. No machining required; the sash can be removed for inspection and maintenance as desired.

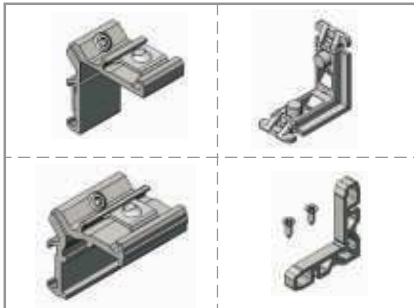

Corner joints

GIESSE has developed a special sash corner joint for the GOS-S system, using an innovating mounting system which gives the corner great strength and solidity.

A variety of corner joints are also available for mounting the frame corner.

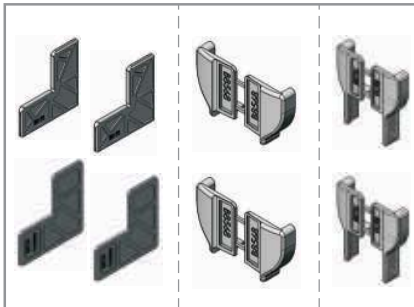

Plastic fittings

GIESSE's GOS-S system is completed by a range of fittings like sash alignment corner joints and drip (or condensation) profile caps.

GIESSE **GOS-S T-REX SYSTEM**

Types that can be created

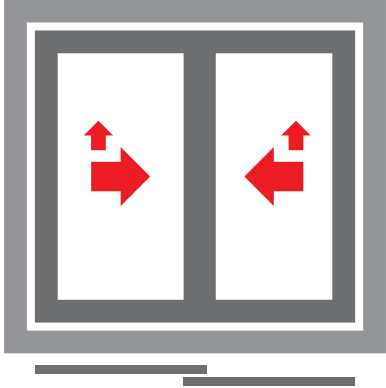

WINDOW
Load capacity: 80 kg per sash

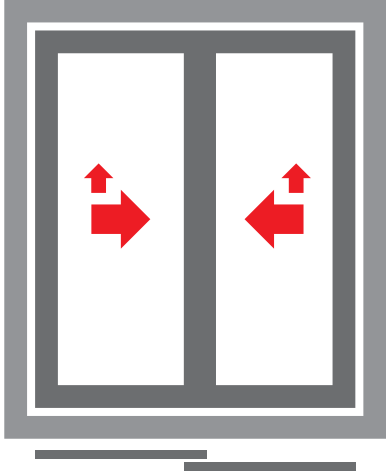

DOOR
Load capacity: 200 kg per sash

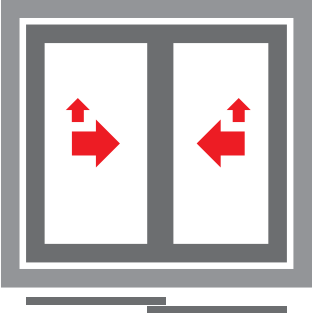

2 SASHES

- 2 mobile sashes
- 1 mobile, 1 fixed

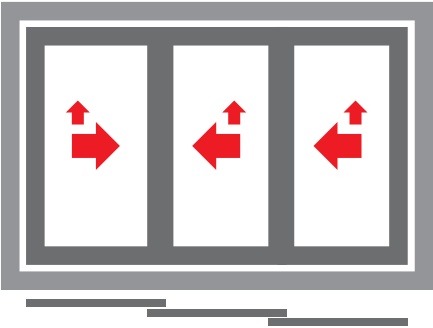

3 SASHES

- 3 mobile sashes
- 2 mobile, 1 fixed

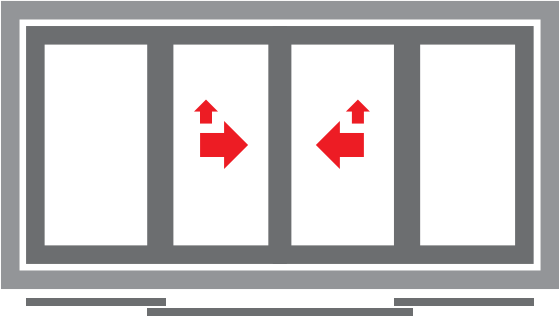

4 SASHES

- 4 mobile sashes
- 2 mobile, 2 fixed

GIESSE GOS-S T-REX SYSTEM

Configurations

GOS-S T-REX L&S DOOR WITH CREMONE SASH 45 mm - TWO MOBILE SASHES

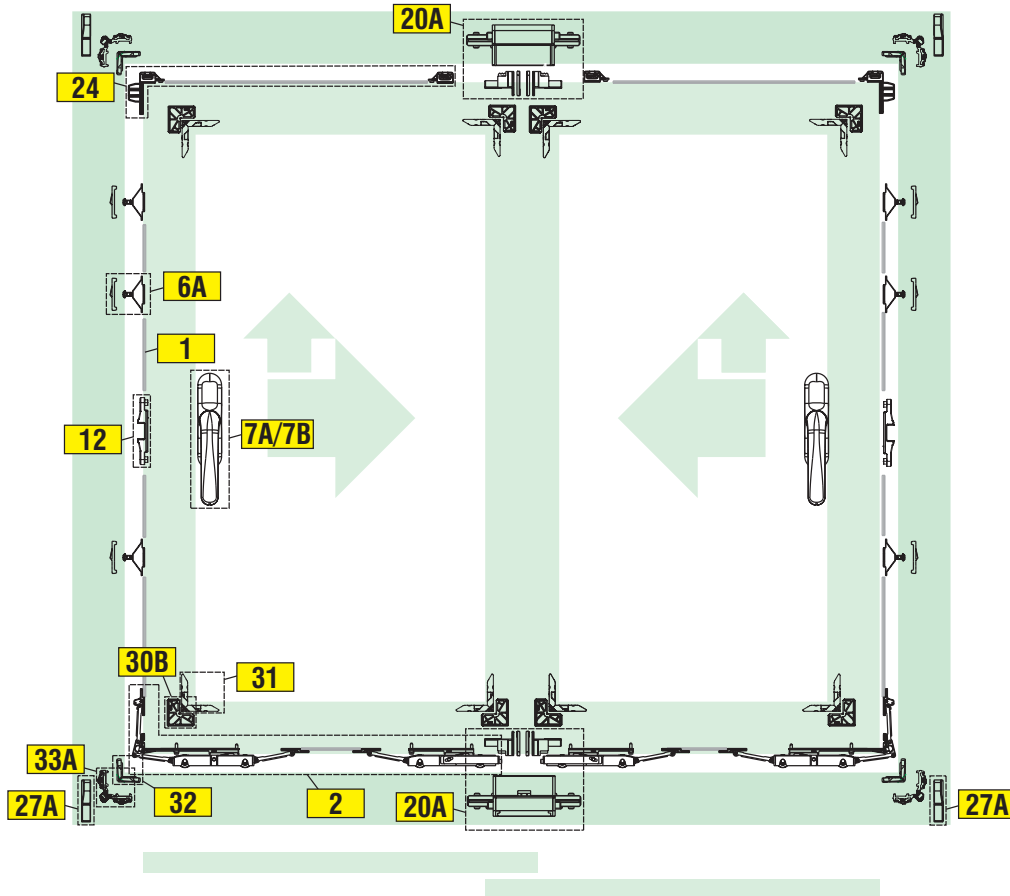

Number	Code	Description	Quantity
1	03524590	CONNECTION ROD	
6A	02929000	KIT FOR MOUNTING FRAME TO OPEN RAIL GOS-S	6
12	02940000	CREMONE DRIVE ROD	2
7A-7B	01058...R	PRIMA RAPID/EURO RAPID	2
2	02913000	KIT CREMONE GOS-S L&S 2-WHEEL CARRIAGES + MECHANISM	2
24	02939000	KIT OF SHOCK ABSORBER AND RISE-PROOF PLUGS GOS-S L&S	2
20A	02936000	KIT OF CENTRAL PLUGS GOS-S T-REX L&S	1
27A	02938000	PAIR OF DRIP PROFILE CAPS RH/LH GOS-S T-REX	2
30B	02921000	SASH ALIGNMENT CORNER JOINTS GOS-S 45 mm WITH PROVISION FOR ARMOUR PLATING	16
31	02923000N	SASH CORNER JOINT GOS-S	8
32	02922000	CORNER JOINT 1 FRAME GOS-S T-REX	4
33A	00336000	CORNER JOINT 2 FRAME GOS-S T-REX	4

GOS-S T-REX L&S DOOR WITH CREMONE
SASH 45 mm - 1 FIXED, 1 MOBILE

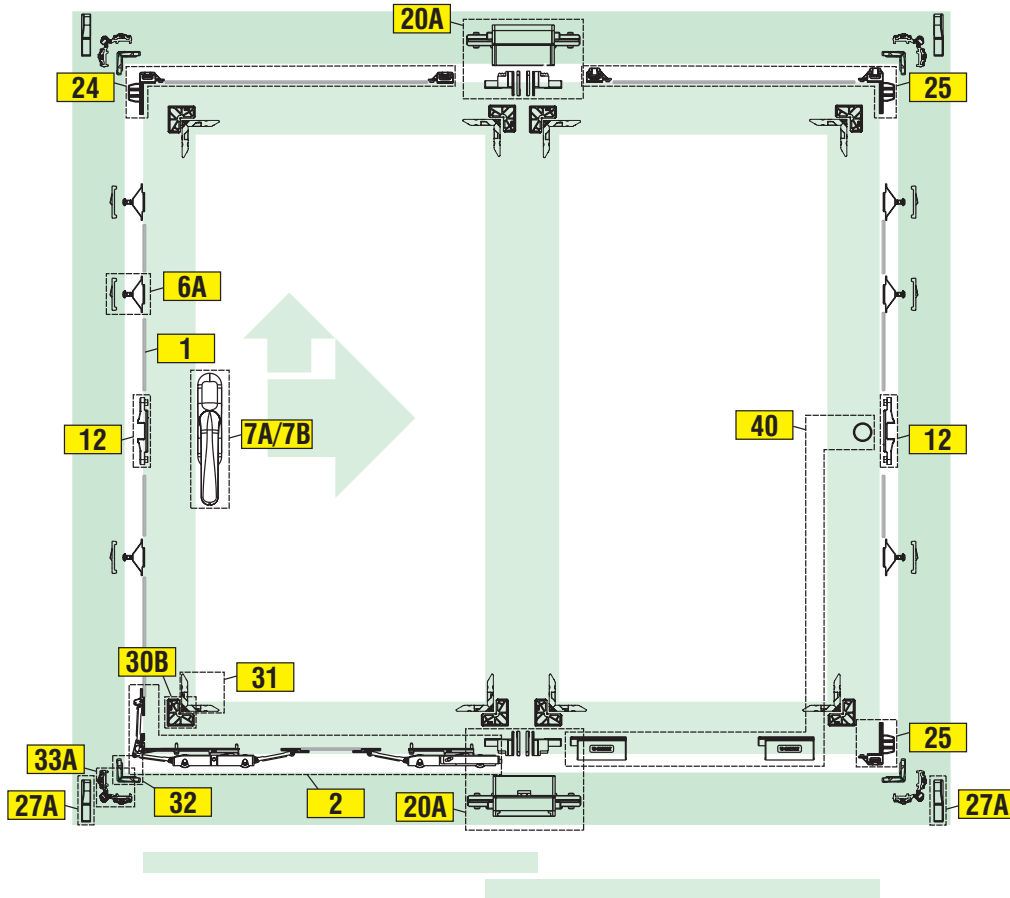

Number	Code	Description	Quantity
1	03524590	CONNECTION ROD	
6A	02929000	KIT FOR MOUNTING FRAME TO OPEN RAIL GOS-S	6
12	02940000	CREMONE DRIVE ROD	2
7A-7B	01058...R	PRIMA RAPID/EURO RAPID	1
2	02913000	KIT CREMONE GOS-S L&S 2-WHEEL CARRIAGES + MECHANISM	1
24	02939000	KIT OF SHOCK ABSORBER AND RISE-PROOF PLUGS GOS-S L&S	1
20A	02936000	KIT OF CENTRAL PLUGS GOS-S T-REX L&S	1
27A	02938000	PAIR OF DRIP PROFILE CAPS RH/LH GOS-S T-REX	2
30B	02921000	SASH ALIGNMENT CORNER JOINTS GOS-S 45 mm WITH PROVISION FOR ARMOUR PLATING	16
31	02923000N	SASH CORNER JOINT GOS-S	8
32	02922000	CORNER JOINT 1 FRAME GOS-S T-REX	4
33A	00336000	CORNER JOINT 2 FRAME GOS-S T-REX	4
40	02954000	FIXED SASH	1
25	02933000	KIT OF SHOCK ABSORBER AND RISE-PROOF PLUGS GOS-S SLIDE	1

GIESSE **GOS-S T-REX SYSTEM**

Configurations

GOS-S T-REX L&S DOOR WITH WINDOW HANDLE SASH 45 mm - TWO MOBILE SASHES

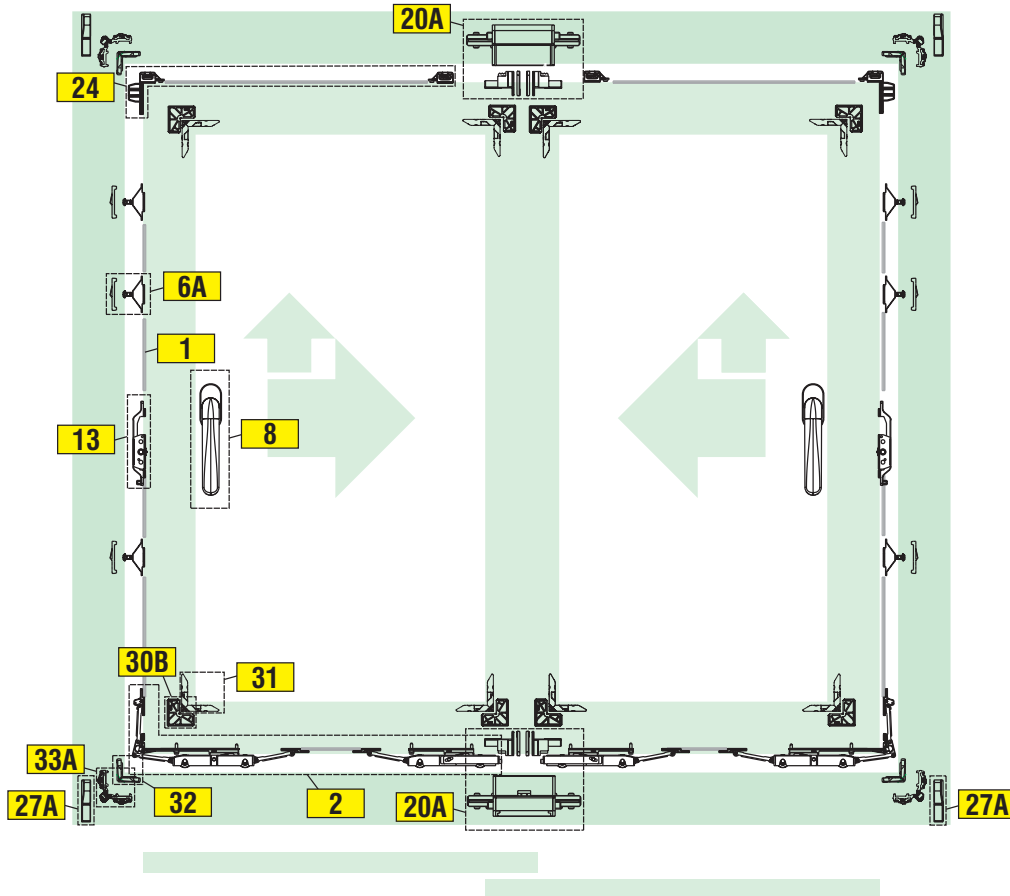

Number	Code	Description	Quantity
1	03524590	CONNECTION ROD	
6A	02929000	KIT FOR MOUNTING FRAME TO OPEN RAIL GOS-S	6
13	02951000	WINDOW HANDLE MECHANISM	2
8	VARIOUS	WINDOW HANDLE	2
2	02913000	KIT CARRIAGES GOS-S L&S 2-WHEEL + MECHANISM	2
24	02939000	KIT OF SHOCK ABSORBER AND RISE-PROOF PLUGS GOS-S L&S	2
20A	02936000	KIT OF CENTRAL PLUGS GOS-S T-REX L&S	1
27A	02938000	PAIR OF DRIP PROFILE CAPS RH/LH GOS-S T-REX	2
30B	02921000	SASH ALIGNMENT CORNER JOINTS GOS-S 45 mm WITH PROVISION FOR ARMOUR PLATING	16
31	02923000N	SASH CORNER JOINT GOS-S	8
32	02922000	CORNER JOINT 1 FRAME GOS-S T-REX	4
33A	00336000	CORNER JOINT 2 FRAME GOS-S T-REX	4

GOS-S T-REX L&S DOOR WITH WINDOW HANDLE
SASH 45 mm - 1 FIXED, 1 MOBILE

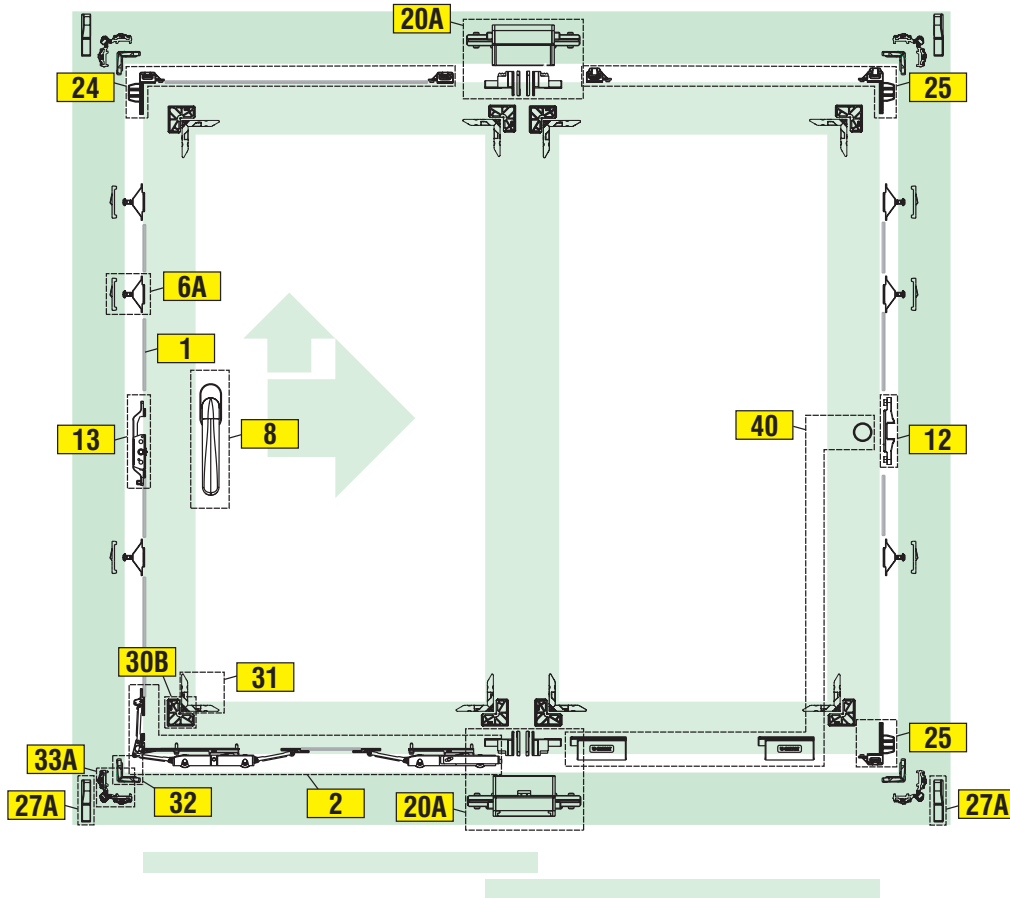

Number	Code	Description	Quantity
1	03524590	CONNECTION ROD	
6A	02929000	KIT FOR MOUNTING FRAME TO OPEN RAIL GOS-S	6
13	02951000	WINDOW HANDLE MECHANISM	1
8	VARIOUS	WINDOW HANDLE	1
2	02913000	KIT CARRIAGES GOS-S L&S 2-WHEEL + MECHANISM	1
24	02939000	KIT OF SHOCK ABSORBER AND RISE-PROOF PLUGS GOS-S L&S	1
20A	02936000	KIT OF CENTRAL PLUGS GOS-S T-REX L&S	1
27A	02938000	PAIR OF DRIP PROFILE CAPS RH/LH GOS-S T-REX	2
30B	02921000	SASH ALIGNMENT CORNER JOINTS GOS-S 45 mm WITH PROVISION FOR ARMOUR PLATING	16
31	02923000N	SASH CORNER JOINT GOS-S	8
32	02922000	CORNER JOINT 1 FRAME GOS-S T-REX	4
33A	00336000	CORNER JOINT 2 FRAME GOS-S T-REX	4
40	02954...	FIXED SASH KIT	1
25	02933000	KIT OF SHOCK ABSORBER AND RISE-PROOF PLUGS GOS-S SLIDE	1
12	02940000	CREMONE DRIVE ROD	1

GIESSE GOS-S T-REX SYSTEM

Configurations

GOS-S T-REX L&S DOOR WITH WINDOW HANDLE AND LOCK with double cylinder
SASH 45 mm - TWO MOBILE SASHES

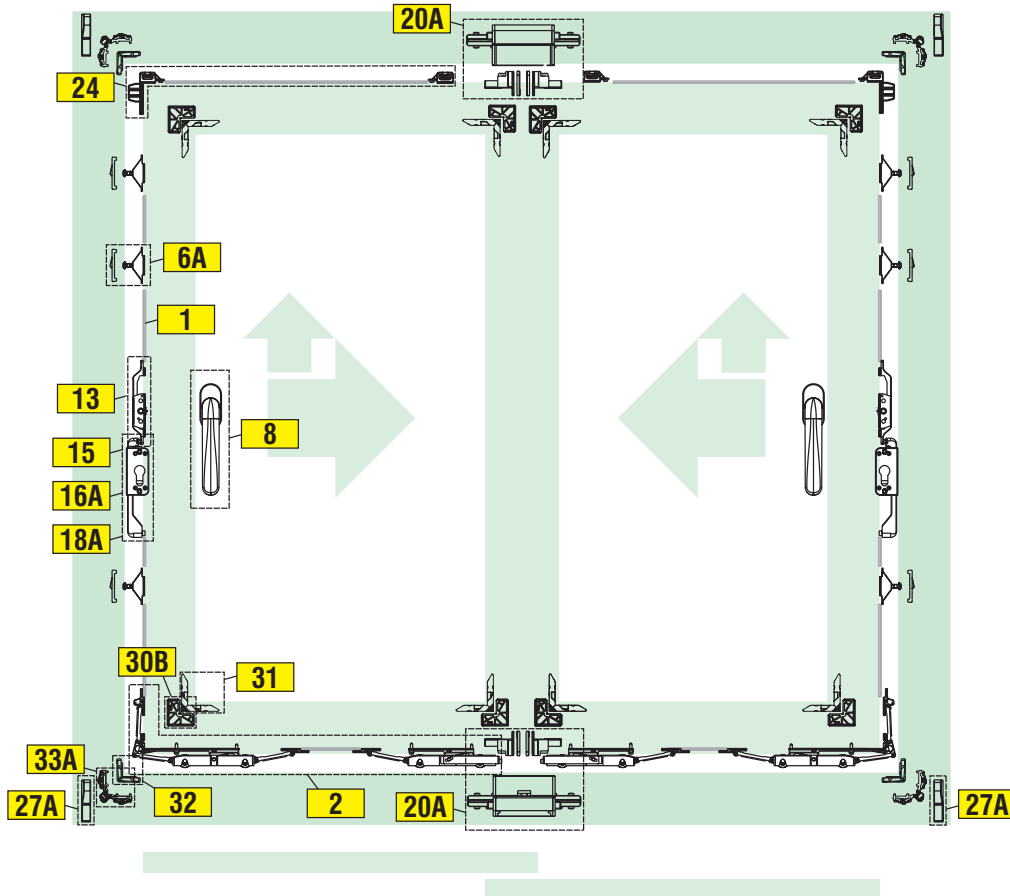

Number	Code	Description	Quantity
1	03524590	CONNECTION ROD	
6A	02929000	KIT FOR MOUNTING FRAME TO OPEN RAIL GOS-S	6
13	02951000	WINDOW HANDLE MECHANISM	2
8	VARIOUS	WINDOW HANDLE	4
15	02952...	SECURITY LOCK WITH KEY AND COVER BOSS	2
16A	02957...	EXTERNAL BOSS AND GUARD FOR LOCK CYLINDER	2
18A	07680000	CENTRAL SYMMETRICAL DOUBLE CYLINDER (EUROPE PROFILE) FOR GOS-S WINDOW/DOOR	2
2	02913000	KIT CARRIAGES GOS-S L&S 2-WHEEL + MECHANISM	2
24	02939000	KIT OF SHOCK ABSORBER AND RISE-PROOF PLUGS GOS-S L&S	2
20A	02936000	KIT OF CENTRAL PLUGS GOS-S T-REX L&S	1
27A	02938000	PAIR OF DRIP PROFILE CAPS RH/LH GOS-S T-REX	2
30B	02921000	SASH ALIGNMENT CORNER JOINTS GOS-S 45 mm WITH PROVISION FOR ARMOUR PLATING	16
31	02923000N	SASH CORNER JOINT GOS-S	8
32	02922000	CORNER JOINT 1 FRAME GOS-S T-REX	4
33A	00336000	CORNER JOINT 2 FRAME GOS-S T-REX	4

**GOS-S T-REX L&S DOOR WITH WINDOW HANDLE CLASS 2 with double cylinder
SASH 45 mm - 2 MOBILE SASHES**

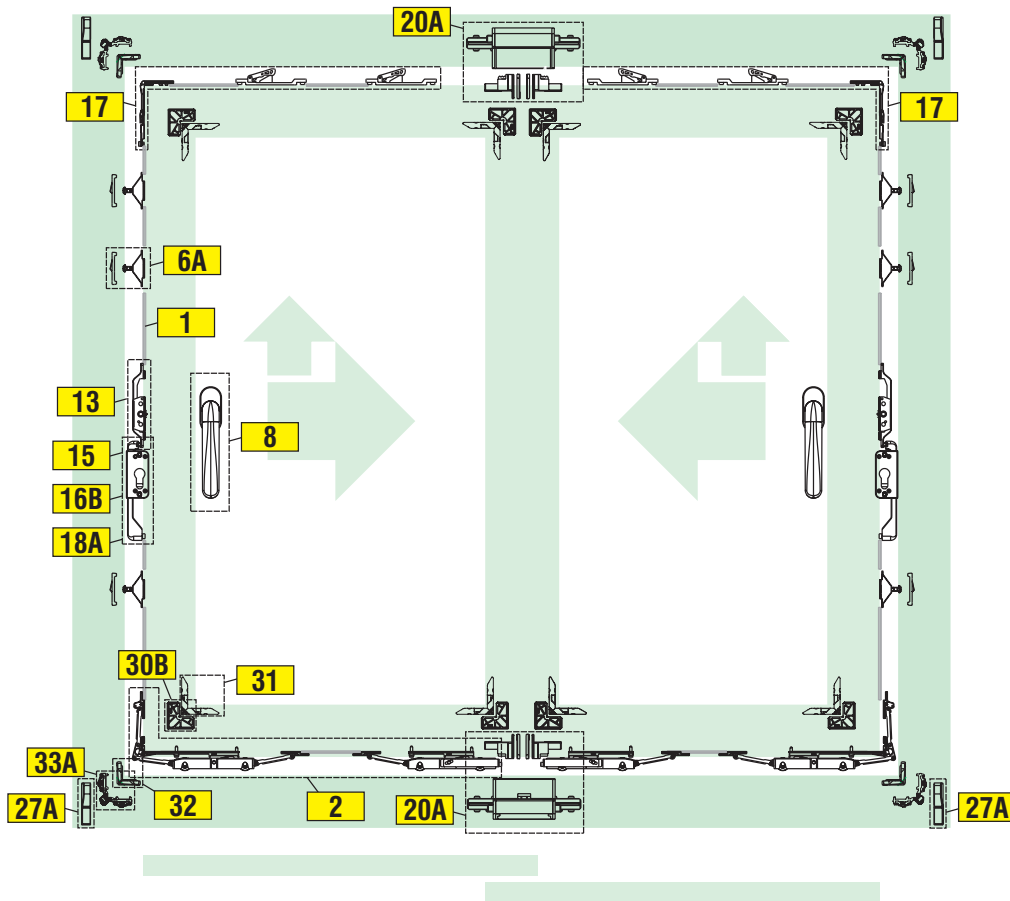

Number	Code	Description	Quantity
1	03524590	CONNECTION ROD	
6A	02929000	KIT FOR MOUNTING FRAME TO OPEN RAIL GOS-S	6
13	02951000	WINDOW HANDLE MECHANISM	2
8	VARIOUS	WINDOW HANDLE	4
15	02952...	SECURITY LOCK WITH KEY AND COVER BOSS	2
16B	02955...	CYLINDER GUARD FOR CLASS 2 ANTI-INTRUSION LOCK	2
18A	07680000	CENTRAL SYMMETRICAL DOUBLE CYLINDER (EUROPE PROFILE) FOR GOS-S WINDOW/DOOR	2
17	02953000	CLASS 2 RISE-PROOF KIT FOR GOS-S L&S	2
2	02913000	KIT CARRIAGES GOS-S L&S 2-WHEEL + MECHANISM	2
24	02939000	KIT OF SHOCK ABSORBER AND RISE-PROOF PLUGS GOS-S L&S	2
20A	02936000	KIT OF CENTRAL PLUGS GOS-S T-REX L&S	1
27A	02938000	PAIR OF DRIP PROFILE CAPS RH/LH GOS-S T-REX	2
30B	02921000	SASH ALIGNMENT CORNER JOINTS GOS-S 45 mm WITH PROVISION FOR ARMOUR PLATING	16
31	02923000N	SASH CORNER JOINT GOS-S	8
32	02922000	CORNER JOINT 1 FRAME GOS-S T-REX	4
33A	00336000	CORNER JOINT 2 FRAME GOS-S T-REX	4

GIESSE GOS-S T-REX SYSTEM

Configurations

WINDOW GOS-S T-REX L&S WITH WINDOW HANDLE and LEVER HANDLE
SASH 45 mm

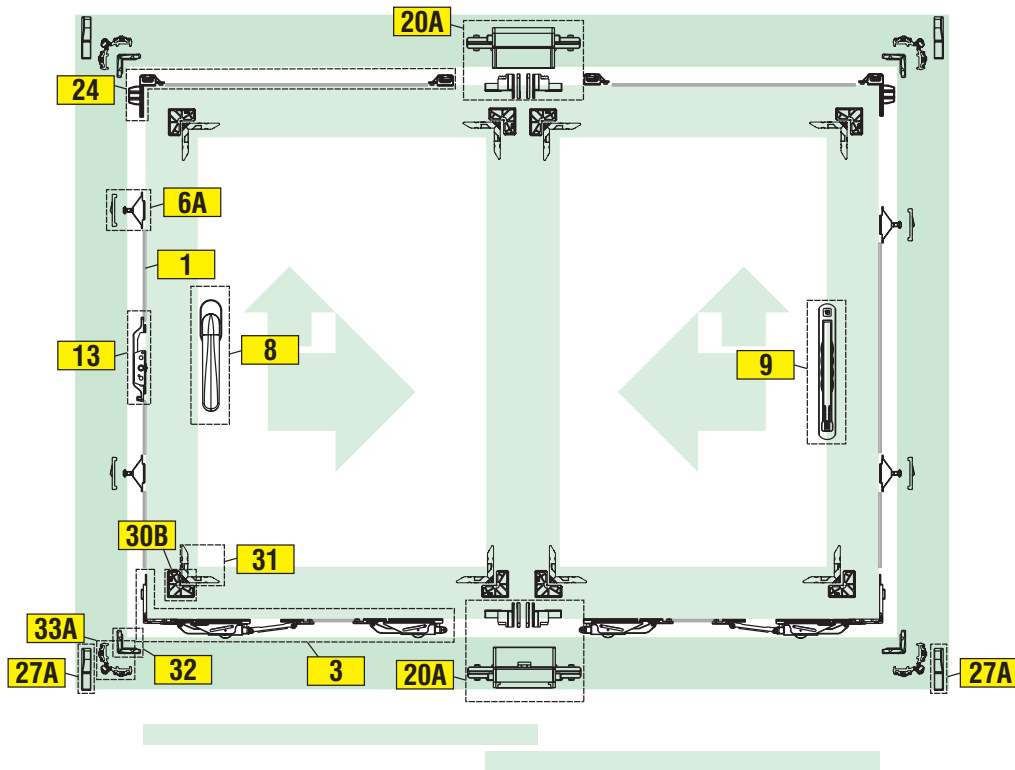

Number	Code	Description	Quantity
1	03524590	CONNECTION ROD	
6A	02929000	KIT FOR MOUNTING FRAME TO OPEN RAIL GOS-S	4
13	02951000	WINDOW HANDLE MECHANISM	1
8	VARIOUS	WINDOW HANDLE	1
9	02942...	BUILT-IN HANDLE WITH 180° LEVER GOS-S L&S	1
3	02912000	KIT CARRIAGES GOS-S L&S 1-WHEEL + CORNER	2
24	02939000	KIT OF SHOCK ABSORBER AND RISE-PROOF PLUGS GOS-S L&S	2
20A	02936000	KIT OF CENTRAL PLUGS GOS-S T-REX L&S	1
27A	02938000	PAIR OF DRIP PROFILE CAPS RH/LH GOS-S T-REX	2
30B	02921000	SASH ALIGNMENT CORNER JOINTS GOS-S 45 mm WITH PROVISION FOR ARMOUR PLATING	16
31	02923000N	SASH CORNER JOINT GOS-S	8
32	02922000	CORNER JOINT 1 FRAME GOS-S T-REX	4
33A	00336000	CORNER JOINT 2 FRAME GOS-S T-REX	4

WINDOW GOS-S T-REX L&S WITH DOUBLE LEVER HANDLE
SASH 45 mm

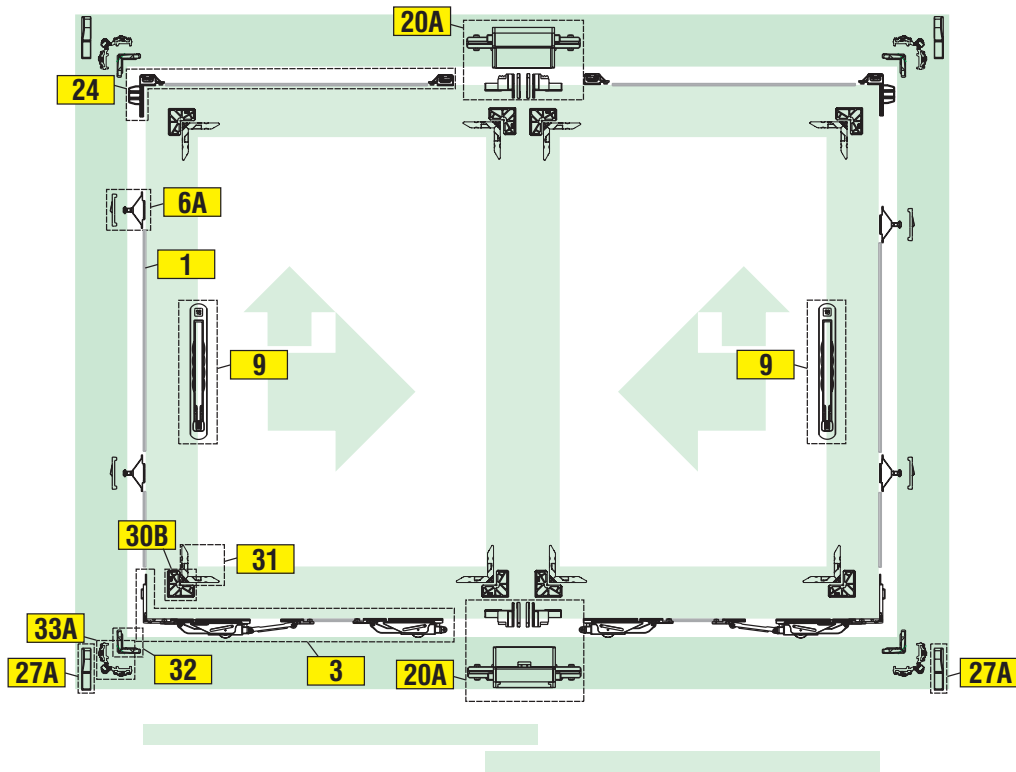

Number	Code	Description	Quantity
1	03524590	CONNECTION ROD	
6A	02929000	KIT FOR MOUNTING FRAME TO OPEN RAIL GOS-S	4
9	02942...	BUILT-IN HANDLE WITH 180° LEVER GOS-S L&S	2
3	02912000	KIT CARRIAGES GOS-S L&S 1-WHEEL + CORNER	2
24	02939000	KIT OF SHOCK ABSORBER AND RISE-PROOF PLUGS GOS-S L&S	2
20A	02936000	KIT OF CENTRAL PLUGS GOS-S T-REX L&S	1
27A	02938000	PAIR OF DRIP PROFILE CAPS RH/LH GOS-S T-REX	2
30B	02921000	SASH ALIGNMENT CORNER JOINTS GOS-S 45 mm WITH PROVISION FOR ARMOUR PLATING	16
31	02923000N	SASH CORNER JOINT GOS-S	8
32	02922000	CORNER JOINT 1 FRAME GOS-S T-REX	4
33A	00336000	CORNER JOINT 2 FRAME GOS-S T-REX	4

www.giesse.it



 **GIESSE**®



U0149000/05-2010